

1 Existing / Demolition Plan

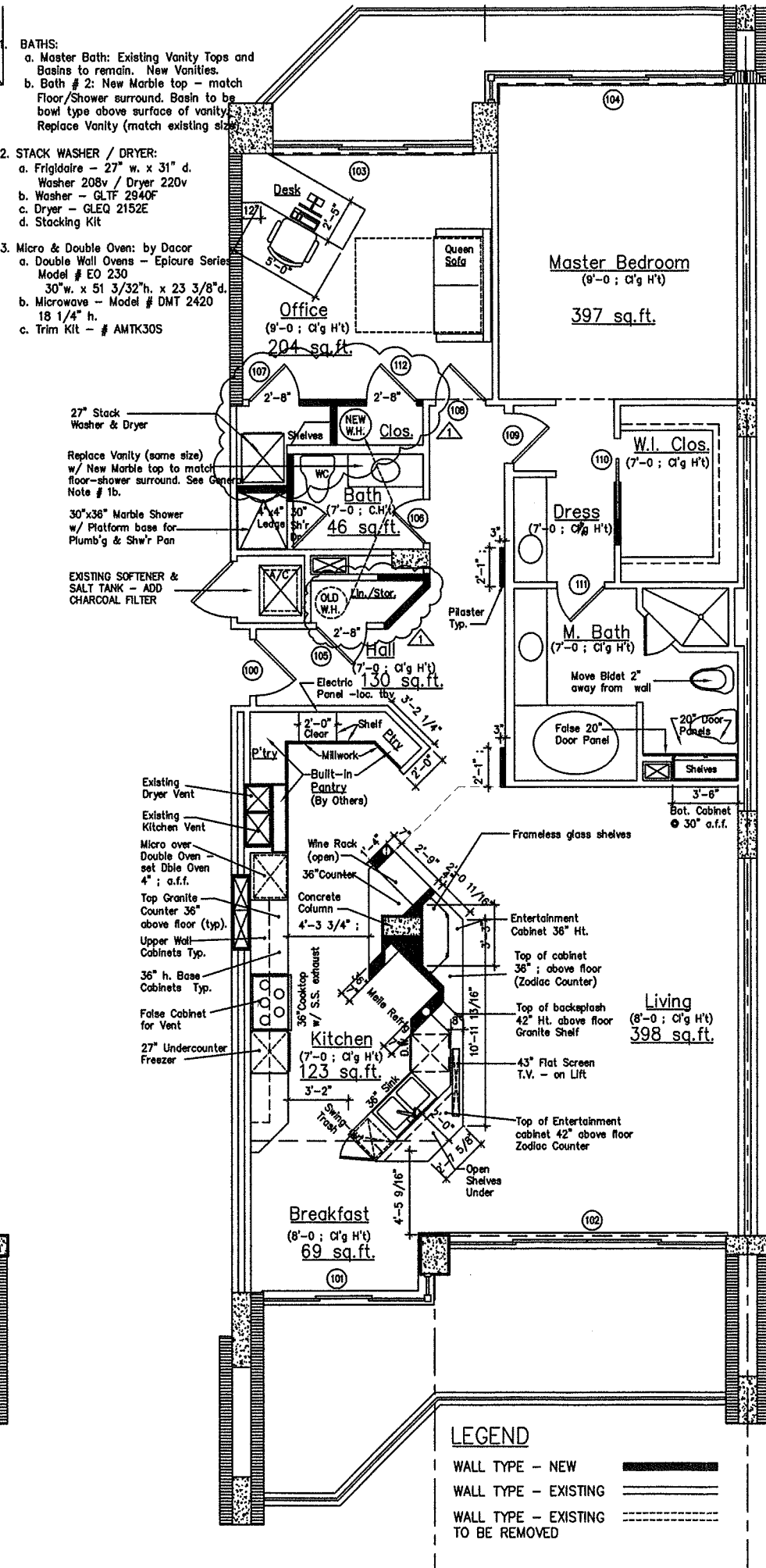

2 FLOOR PLAN

- BATHS:**
- a. Master Bath: Existing Vanity Tops and Basins to remain. New Vanities.
 - b. Bath # 2: New Marble top - match Floor/Shower surround. Basin to be bowl type above surface of vanity. Replace Vanity (match existing size).
- 2. STACK WASHER / DRYER:**
- a. Frigidaire - 27" w. x 31" d. Washer 208v / Dryer 220v
 - b. Washer - GLTF 2940F
 - c. Dryer - GLEQ 2152E
 - d. Stacking Kit
- 3. Micro & Double Oven: by Dacor**
- a. Double Wall Ovens - Epicure Series Model # EO 230
30" w. x 51 3/32" h. x 23 3/8" d.
 - b. Microwave - Model # DMT 2420
18 1/4" h.
 - c. Trim Kit - # AMTK30S

- LEGEND**
- WALL TYPE - NEW
 - WALL TYPE - EXISTING
 - WALL TYPE - EXISTING TO BE REMOVED

NOTE:
THESE SCHEMATIC PLANS ARE PREPARED WITH THE CLIENTS DIRECTION TO BE USED IN WHOLE OR PART BY A DESIGN PROFESSIONAL REGISTERED IN FLORIDA FOR THE PURPOSE OF SEEKING ALL NECESSARY PERMITS.

GENERAL NOTES:

1. BATHS:
 - a. Master Bath: Existing Vanity Tops and Basins to remain. New Vanities.
 - b. Bath # 2: New Marble top - match Floor/Shower surround. Basin to be bowl type above surface of vanity. Replace Vanity (match existing size).
2. STACK WASHER / DRYER:
 - a. Frigidaire - 27" w. x 31" d. Washer 208v / Dryer 220v
 - b. Washer - GLTF 2940F
 - c. Dryer - GLEQ 2152E
 - d. Stacking Kit
3. Micro & Double Oven: by Dacor
 - a. Double Wall Ovens - Epicure Series Model # EO 230
30" w. x 51 3/32" h. x 23 3/8" d.
 - b. Microwave - Model # DMT 2420
18 1/4" h.
 - c. Trim Kit - # AMTK30S
4. REFRIGERATOR:
 - a. Miele: Left Hinged
36" w. x 80" h. x 24" d.
5. UNDERCOUNTER FREEZER:
 - a. Freezer: Model # 700BF/BF1
34 1/2" h. x 27" w. x 24" d.
6. COOKTOP:
 - a. Wolf - Model # CT36EV
36" Cooktop
 - b. Hood Liner: Integrated Model # IHL36 - S.S.
 - c. Cooktop Updraft Vent
7. DISHWASHER:
 - a. Miele - Model G 2XXX
8. KITCHEN COUNTER:
 - a. Granite
9. FLOORING:
 - a. Engineered EKO Wood Flooring 6" x 84".
10. Relocate existing Mechanical/Electrical Utilities in Ceiling as required, co-ordinate all trades.
11. MECHANICAL ROOM: add damper at top, in duct - thermostat east & west and humidistat.
12. WATER HEATER: Marathon 75 gallon Model # MR75245. Fiberglass.
13. KITCHEN AREA:
 - All Drywall to be removed and replaced with new.
14. LIVING, DINING AND HALLWAY:
 - All drywall having knockdown texture to be removed and replaced with new drywall having orange peel painted texture. (Prime plus two coats)
15. BASEBOARD:
 - All affected baseboard to be replaced with matching.

ALL WORK TO BE DONE ACCORDING TO CURRENT FL. BLDG. CODE 2007
LEVEL OF ALTERATION OF FL. BLDG. CODE SECTION 401, IS LEVEL 2
CONDOMINIUM IS A TYPE 1 LEVEL CONSTRUCTION
NO. OF STORIES OF CONDOMINIUM TOWER IS 17
NO. OF SQ. FT. IN CONDOMINIUM UNIT IS 1,582

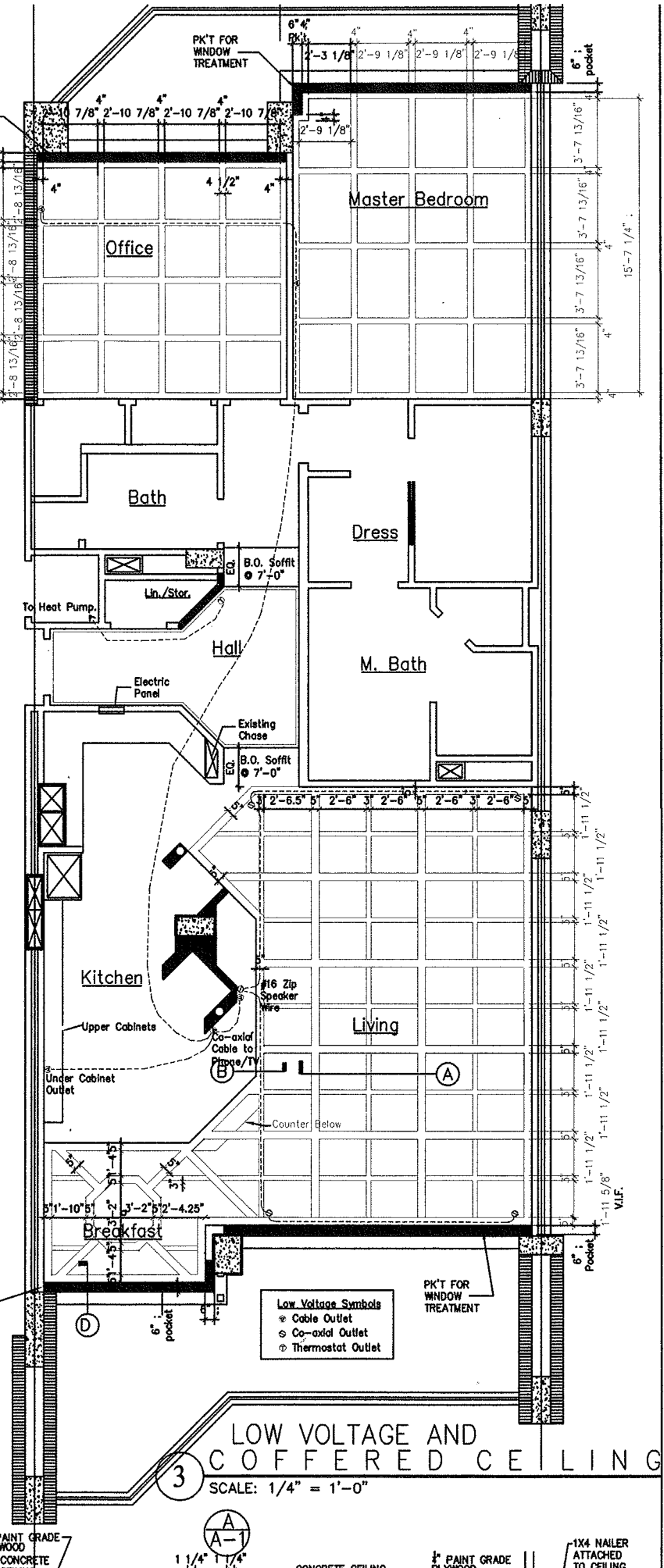

LOW VOLTAGE AND COFFERED CEILING

SCALE: 1/4" = 1'-0"

SHIELD CONSULTING ENGINEERS INC.
C.A. 27455
7103 W. SUNRISE BLVD. SUITE B-2
PLANTATION, FLORIDA 33313
TEL: (954) 257-3401 FAX: (954) 321-6430

CONDOMINIUM REMODEL
WARREN & JILL FABEL
4101 N. OCEAN BLVD. # 1704
BOCA RATON FL. 33431

DRAWN	S. B. S.
CHECKED	
DATE	06-24-0
SCALE	AS NOTED
JOB NO.	
SHEET	